

## TECHNICAL FEATURES



### Description

Luminous device for the escape routes of the tunnels. Compliant with EN16276.

### OPTICAL FEATURES

Light source	6 LEDs	
Optics	Compliant with EN16276	
Optical group lifetime	> 100'000 hours	
Colour	White (6000 K)	Green (525 nm)
Luminous intensity	> 15 cd steady light	100 cd flashing mode 0,2 ÷ 2Hz
Luminous intensity (low-power mode)	< 1 cd steady light	< 20 cd steady light

### ELECTRICAL FEATURES

Power	5 W (0.5 W low-power mode)	6 W (1 W low-power mode)
Supply voltage	12 ÷ 48 Vdc SELV	
Connections	Internal on ceramic clamps, resistant to heat (max 1'000°C)	
Cables and cable glands	Maximum section 6 mm <sup>2</sup> ; PG16 cable glands (PG20 on request)	
Protections	Reverse polarity; Overvoltages; Overcurrents	
Insulation class	Class III	
Control system	<ul style="list-style-type: none"> <li>•Third Wire with PWM (100 Hz ÷ 1 KHz, 0 ÷ 100% DC, MAX 48V)</li> <li>•Voltage Change (24V-48V)</li> <li>•Reverse Polarity</li> </ul>	

### MECHANICAL FEATURES

IP protection class	IP65
IK code	IK10
Material	Polycarbonate V0 UL94 - Inox AISI 304
Dimensions	286 x 144 x 110 mm
Total weight	500 g
Operating temperature	-20 °C ÷ +40 °C
Fixing	<ul style="list-style-type: none"> <li>•2 holes for fixing to the wall</li> <li>•Spacer for direct wall mounting with lateral cable exit</li> </ul>

### INSTALLATION

Installation height	1 m (MAX 1.5 m)
Interdistance	12.5 m (MAX 25 m)

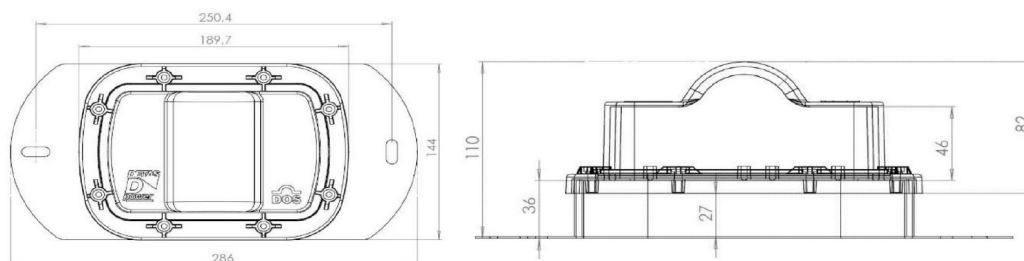

Rev. 3.0  
23/12/2022



Approved TEC



Approved AQ